

# #60226 SERIES DUAL ADJUSTABLE LCD DISPLAY ARM USER GUIDE

**Recommended load capacity**  
Please check the weight of your LCD panel and make sure its weight is suitable for the arm loading range.

\* #26-21-52 weight capacity 2-12 lbs

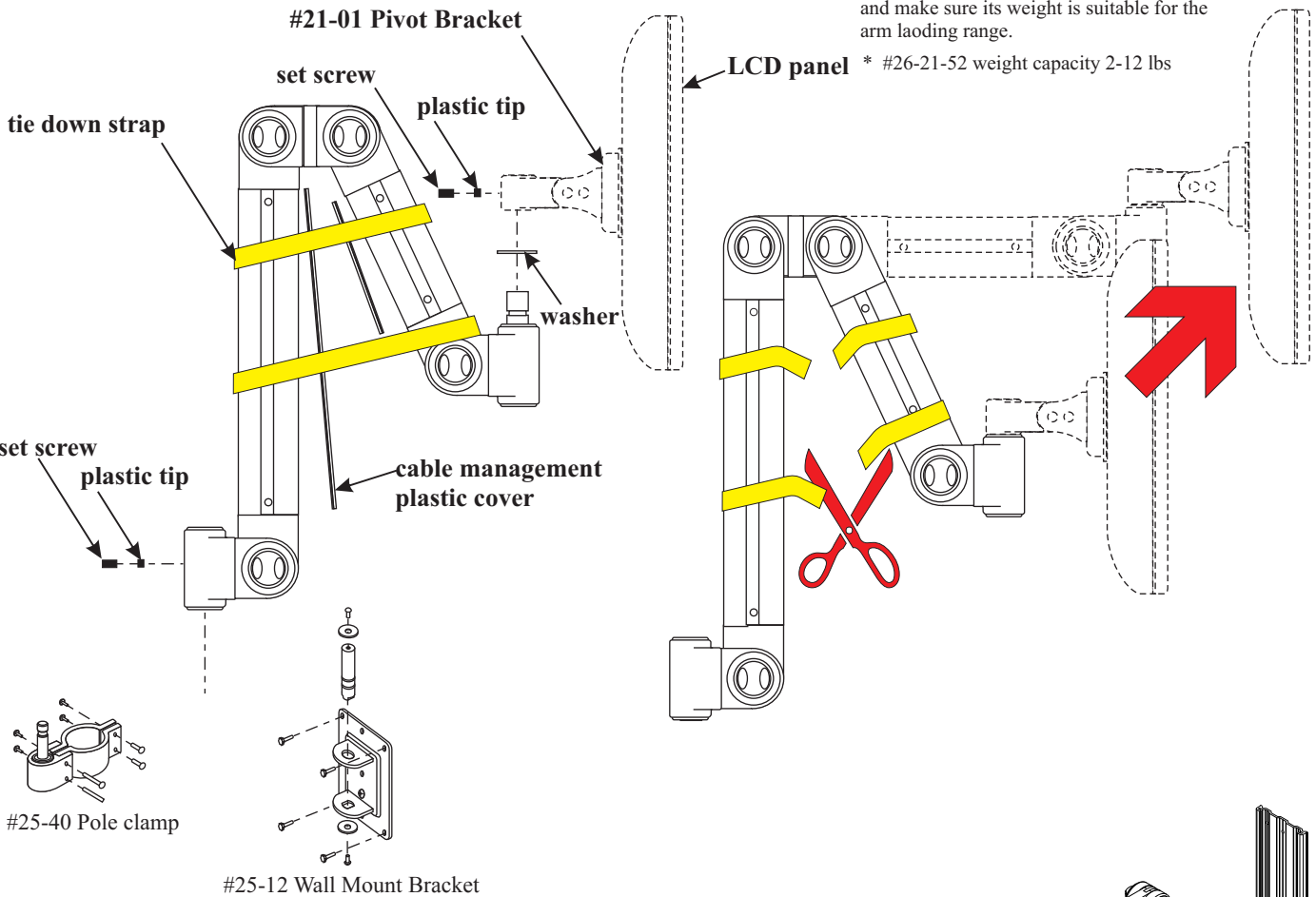

VESA 75mm to VESA 100mm conversion plate installation guide

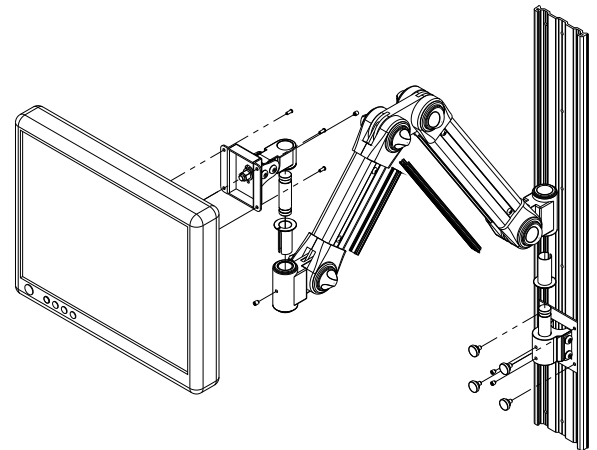
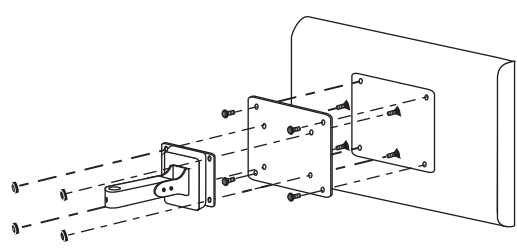

## CAUTION

**This arm contains internal mechanisms under tension. Keep the cable tie in place until arm is well installed on its mount and the device is well attached to the arm to avoid serious injury.**